

# Aptos Village Parcel For Sale

## \$275,000



## PROPERTY HIGHLIGHTS

- VACANT PARCEL in APTOS VILLAGE
- ZONING: SU SPECIAL USES
- 13,460 +/- SQ. FT. / 0.31 ACRES
- RESIDENTIAL, MULTI-RES, OFFICE, RETAIL, or MIXED USE
- NEIGHBORING RETAILERS INCLUDE STARBUCKS, QUIZNOS, CAFÉ SPARROW, BAY FEDERAL

**Presented exclusively by:**

**CHRIS SHOEMAKER, CCIM**

Broker / Owner DRE # 01760812

Office: 831.476.8194 ext. 34

[chris@hirschandassociates.com](mailto:chris@hirschandassociates.com)



**HIRSCH AND ASSOCIATES**

Investment Real Estate Brokers: Sales & Leasing

4375 Capitola Road Capitola, CA 95010

831.476.8194 | [www.hirschandassociates.com](http://www.hirschandassociates.com)

# DISCLAIMER



This brochure has been prepared to provide summary information to prospective purchasers and to establish a preliminary level of interest in the property presented. It does not, however, purport to present all material information regarding the subject property, and it is not a substitute for thorough due diligence investigation. In particular, Hirsch and Associates has not made any investigation, and makes no warranty or representation with respect to the financial condition or business prospects of any tenant, or any tenant's plans or intentions to continue or renew its occupancy of the subject property. The information contained in this brochure has been obtained from sources we believe to be reliable; however, we make no warranty or representation whatsoever regarding the accuracy or completeness of the information provided.

**IMPROVEMENTS, SIZE AND BOUNDARIES:** Any oral or written representations by Seller or Broker regarding age of improvements, size and square footage of parcel or building, or location of property lines may not be accurate. Apparent boundary line indicators such as fences, hedges, walls or other barriers may not represent the true boundary lines, only a surveyor can determine the actual boundary lines. If any of these issues are important to Buyer's decision to purchase, then Buyer should consider investigating the property independently.

**SHOWING: PROPERTY TO BE SHOWN BY LISTING BROKER ONLY. PLEASE DO NOT WALK THE PROPERTY WITHOUT PRIOR BROKER APPROVAL.**



# TABLE OF CONTENTS



---

Property Summary	4
Parcel Map	5
Street Map	6
Aerial View of Neighboring Businesses	7

---



# PROPERTY SUMMARY



## PROPERTY

Assessor's Parcel Number:	041-021-13
Location:	One block from 11.5 acre Aptos Village development, which will include 71,000 +/- Sq. Ft. of commercial space and 63 new residential units.
Zoning:	SU - Special Use
General Plan:	C-C, O-U - Community Commercial, Urban Open Space
Parcel Size:	0.31 Acres +/- / 13,460 Sq. Ft. +/-
Parking:	Development will provide for on-site parking. There is also street parking.
Area Retailers:	Retailers in the immediate vicinity include Starbucks, Quiznos, Café Sparrow, and Bay Federal





# PARCEL MAP

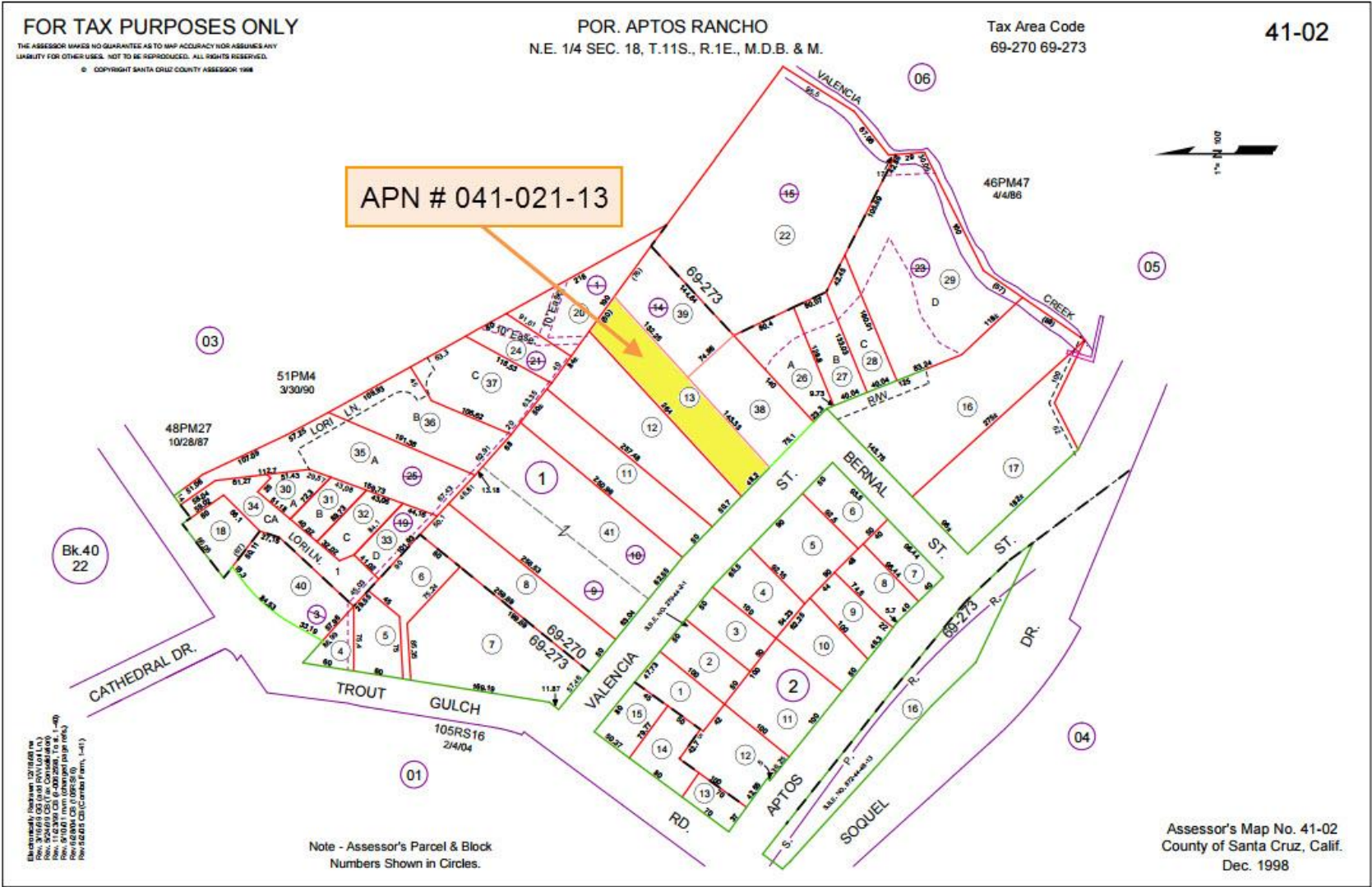

The property owner provided information presented in this proforma. Hirsch and Associates make no representation as to the accuracy of the information. Buyer should use diligence investigating the financial feasibility in making a purchase or lease by relying on his or her own professional advisors.



**Hirsch and Associates**  
 Investment Real Estate Brokers: Sales & Leasing  
 4375 Capitola Road Capitola, CA 95010  
 831.476.8194 | www.hirschandassociates.com

# STREET MAP

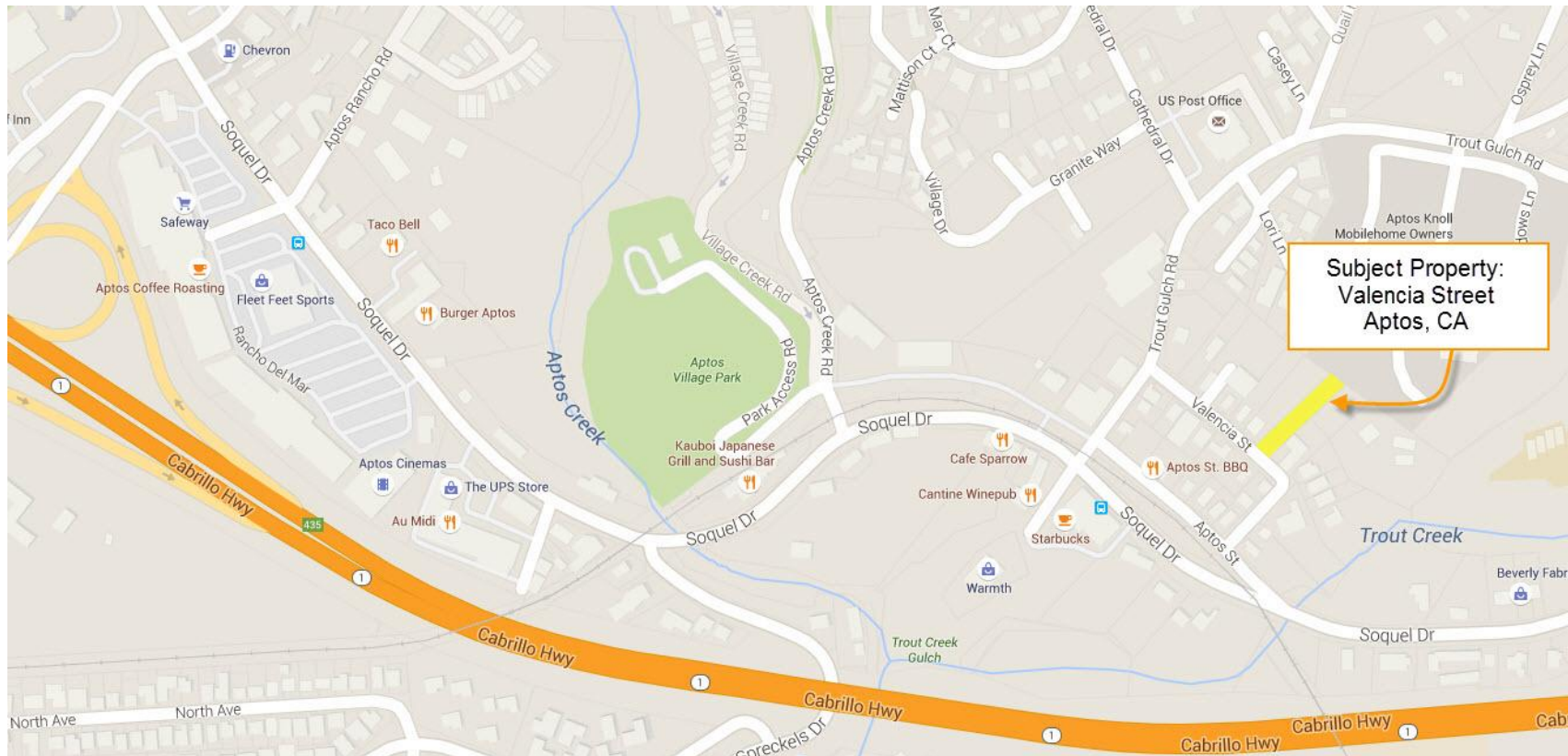

Subject Property:  
Valencia Street  
Aptos, CA





# AERIAL VIEW OF NEIGHBORING BUSINESSES



The property owner provided information presented in this proforma. Hirsch and Associates make no representation as to the accuracy of the information. Buyer should use diligence investigating the financial feasibility in making a purchase or lease by relying on his or her own professional advisors.



**Hirsch and Associates**  
 Investment Real Estate Brokers: Sales & Leasing  
 4375 Capitola Road Capitola, CA 95010  
 831.476.8194 | www.hirschandassociates.com